

LEE OILFIELD SERVICE  
3 5/8 O.D. x 1.8 I.D. TESTING JAR  
PARTS LIST

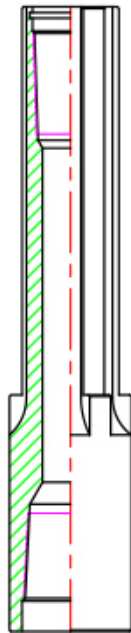

MALE SPLINE  
PART #: FJ-3625BB-01

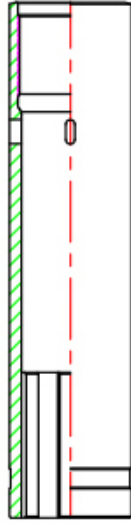

FEMALE SPLINE  
PART #: FJ-3625BB-02

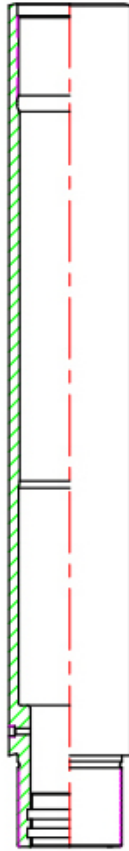

BOWL  
PART #: FJ-3625BB-03

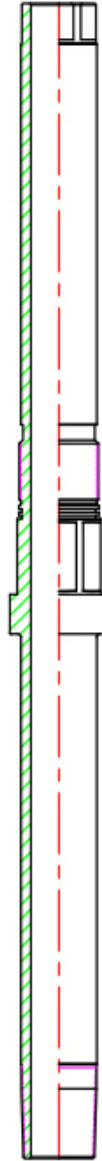

MANDREL  
PART #: FJ-3625BB-05



SNAP RING  
SH-0237

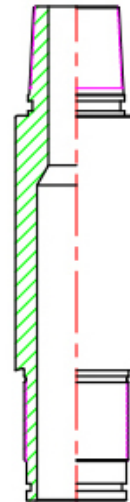

BOTTOM SUB  
PART #: FJ-3625BB-04

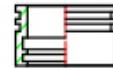

PRESSURE RING  
PART #: FJ-3625BB-08

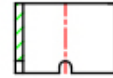

VALVE  
PART #: FJ-3625BB-06

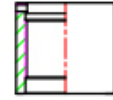

VALVE SEAT  
PART #: FJ-3625BB-07

LEE OILFIELD SERVICE  
3 5/8 O.D. x 1.8 I.D. TESTING JAR

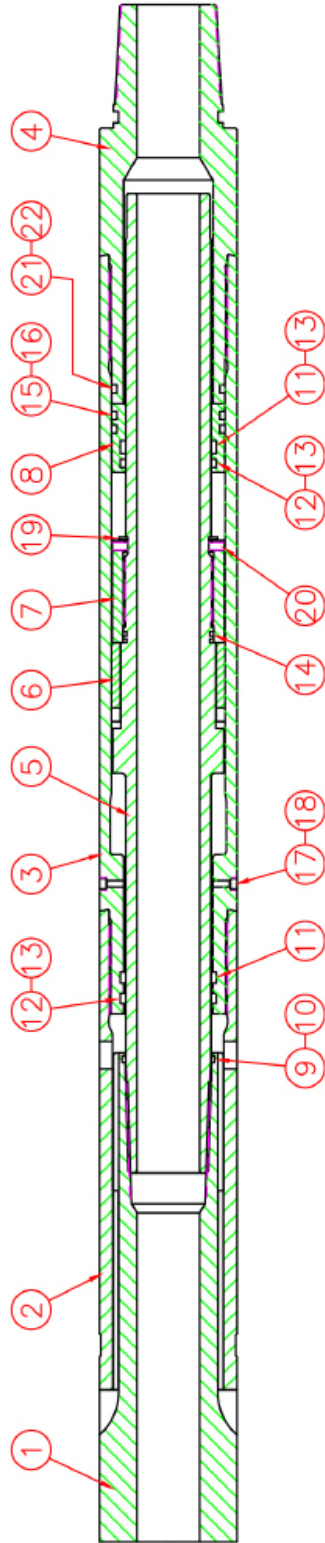

LOCATION	DESCRIPTION	PART NUMBER	QTY
9	O-RING	2-229	1
10	BACKUP	8-229	1
11	SEAL	18702375-375B	2
12	O-RING	2-332	2
13	BACKUP	8-332	4
14	O-RING	2-228	2
15	O-RING	2-334	2
16	BACKUP	8-334	2
17	O-RING	2-006	2
18	7/16" OIL PLUG	OP-716	2
19	SNAP RING	SH-0237	1
20	SOCKET SET SCREW	5/16-24UNF x 5/16	2
21	O-RING	2-232	1
22	BACKUP	8-232	1

LOCATION	DESCRIPTION	PART NUMBER	QTY
1	MALE SPLINE	FJ-3625BB-01	1
2	FEMALE SPLINE	FJ-3625BB-02	1
3	BOWL	FJ-3625BB-03	1
4	BOTTOM SUB	FJ-3625BB-04	1
5	MANDREL	FJ-3625BB-05	1
6	VALVE	FJ-3625BB-06	1
7	VALVE SEAT	FJ-3625BB-07	1
8	PRESSURE RING	FJ-3625BB-08	1

LEE OILFIELD SERVICE  
3 5/8 O.D. x 1.8 I.D. TESTING JAR  
"O"-RING PLACEMENT

