

LEE OILFIELD SERVICE
5 O.D. x 2.3 I.D. TESTING JAR
PARTS LIST

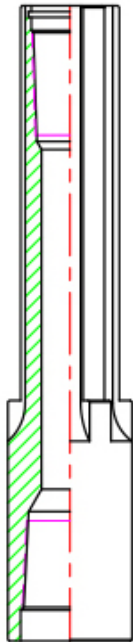

MALE SPLINE
PART #: FJ-5BB-01

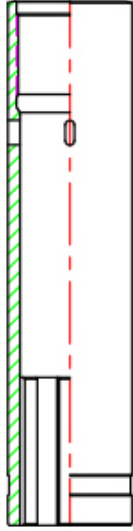

FEMALE SPLINE
PART #: FJ-5BB-02

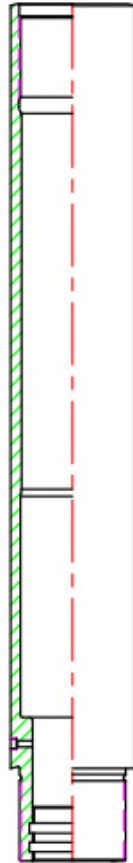

BOWL
PART #: FJ-5BB-03

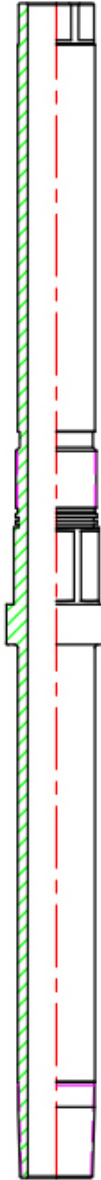

MANDREL
PART #: FJ-5BB-05



SNAP RING
SH-0312

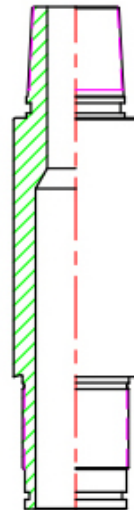

BOTTOM SUB
PART #: FJ-5BB-04

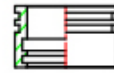

PRESSURE RING
PART #: FJ-5BB-08

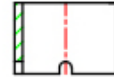

VALVE
PART #: FJ-5BB-06

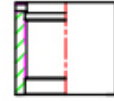

VALVE SEAT
PART #: FJ-5BB-07

LEE OILFIELD SERVICE
5 O.D. x 2.3 I.D. TESTING JAR

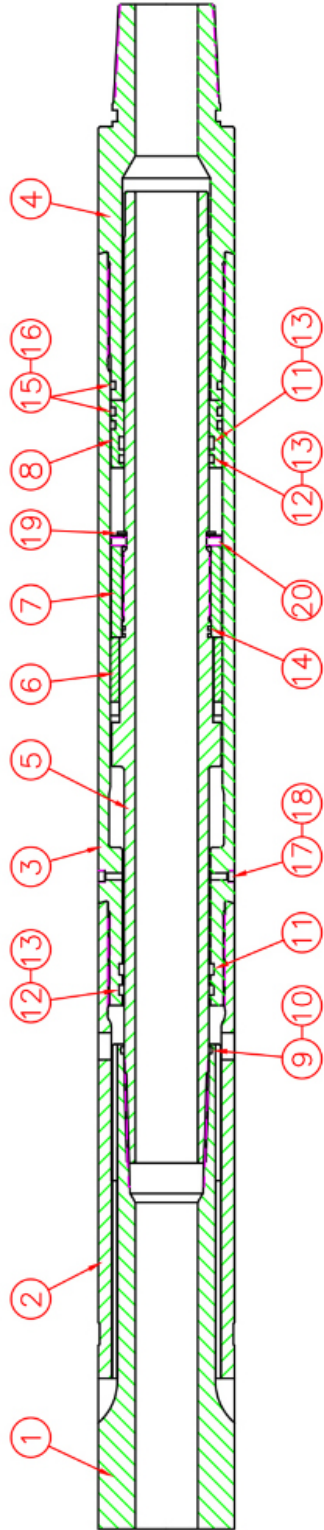

LOCATION	DESCRIPTION	PART NUMBER	QTY
1	MALE SPLINE	FJ-5BB-01	1
2	FEMALE SPLINE	FJ-5BB-02	1
3	BOWL	FJ-5BB-03	1
4	BOTTOM SUB	FJ-5BB-04	1
5	MANDREL	FJ-5BB-05	1
6	VALVE	FJ-5BB-06	1
7	VALVE SEAT	FJ-5BB-07	1
8	PRESSURE RING	FJ-5BB-08	1

LOCATION	DESCRIPTION	PART NUMBER	QTY
9	O-RING	2-235	1
10	BACKUP	8-235	1
11	SEAL	18703125-375B	2
12	O-RING	2-338	2
13	BACKUP	8-338	4
14	O-RING	2-234	2
15	O-RING	2-343	3
16	BACKUP	8-343	3
17	O-RING	2-006	2
18	7/16" OIL PLUG	OP-716	2
19	SNAP RING	SH-0312	1
20	SOCKET SET SCREW	5/16-24UNF x 1/2	2

LEE OILFIELD SERVICE
5 O.D. x 2.3 I.D. TESTING JAR
"O"-RING PLACEMENT

