

LEE OILFIELD SERVICE
3 7/8 O.D. x 1 7/8 I.D. TESTING JAR

PARTS LIST

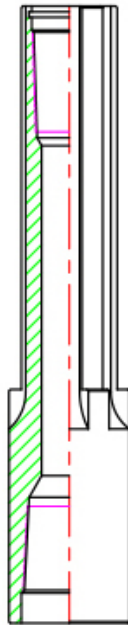

MALE SPLINE
PART #: FJ-3875BB-01

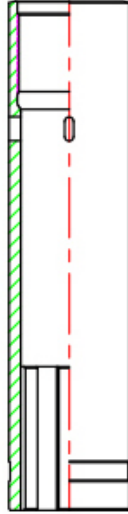

FEMALE SPLINE
PART #: FJ-3875BB-02

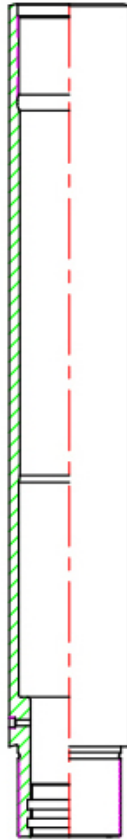

BOWL
PART #: FJ-3875BB-03

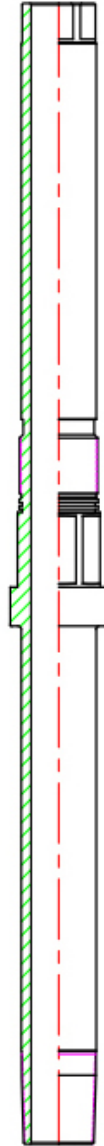

MANDREL
PART #: FJ-3875BB-05



SNAP RING
SH-0250

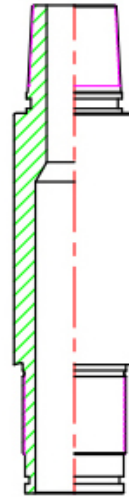

BOTTOM SUB
PART #: FJ-3875BB-04

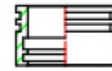

PRESSURE RING
PART #: FJ-3875BB-08

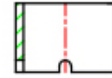

VALVE
PART #: FJ-3875BB-06

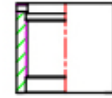

VALVE SEAT
PART #: FJ-3875BB-07

LEE OILFIELD SERVICE
3 7/8 O.D. x 1 7/8 I.D. TESTING JAR

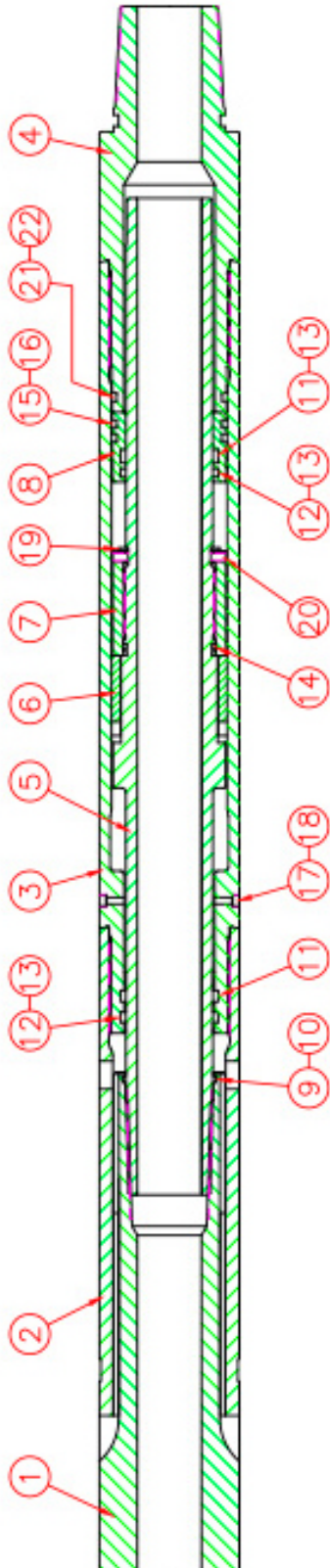

LOCATION	DESCRIPTION	PART NUMBER	QTY
9	O-RING	2-230	1
10	BACKUP	8-230	1
11	SEAL	18702500-375B	2
12	O-RING	2-333	2
13	BACKUP	8-333	4
14	O-RING	2-229	2
15	O-RING	2-335	2
16	BACKUP	8-335	2
17	O-RING	2-006	2
18	7/16" OIL PLUG	OP-716	2
19	SNAP RING	SH-0250	1
20	SOCKET SET SCREW	5/16-24UNFx5/16	2
21	O-RING	2-233	1
22	BACKUP	8-233	1

LOCATION	DESCRIPTION	PART NUMBER	QTY
1	MALE SPLINE	FJ-3875BB-01	1
2	FEMALE SPLINE	FJ-3875BB-02	1
3	BOWL	FJ-3875BB-03	1
4	BOTTOM SUB	FJ-3875BB-04	1
5	MANDREL	FJ-3875BB-05	1
6	VALVE	FJ-3875BB-06	1
7	VALVE SEAT	FJ-3875BB-07	1
8	PRESSURE RING	FJ-3875BB-08	1

LEE OILFIELD SERVICE
3 7/8 O.D. x 1 7/8 I.D. TESTING JAR
"O" -RING PLACEMENT

